

PURELL® Waterless Surgical Scrub

DIRECTIONS FOR USE: Can be used for first scrub of the day and on going throughout the day.

Are my hands clean?

If soiled or dirty, wash with non-medicated soap prior to surgical preparation.

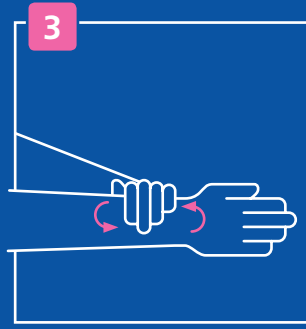
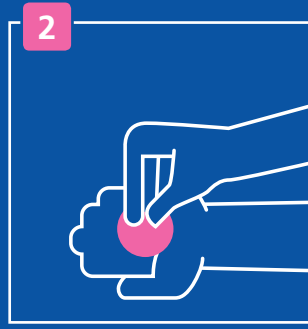
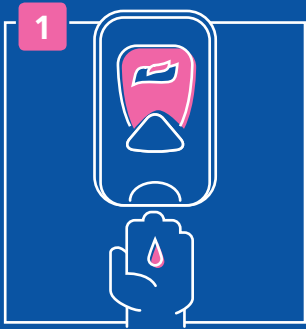

APPLICATION 1

On dry hands, **dispense 2 doses** (plus as needed) into the palm of the left hand.

Dip fingertips of right hand into the product and work under nails.

Spread product evenly in a circular motion of the right hand and forearm, up to the elbow.

APPLICATION 2

Repeat steps 1-3 for the opposite hand and arm.

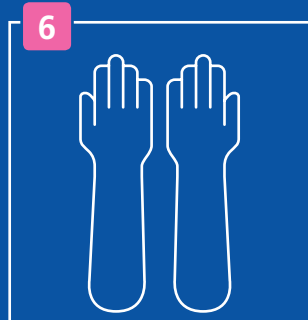
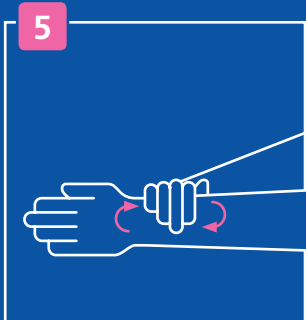

APPLICATION 3

Dispense 2 doses. Cover hands up to wrists. Rub back of hands, wrists, fingers, thumbs and palms.

Allow hands and arms to completely air dry before donning gloves. Hold hands above elbow height during this process.

Ensure sufficient product is used to keep hands and arms wet and rubbed for

120 seconds

VIRTUE +

Our instructions are in accordance with ACORN standards, edition 14.
©2017. GOJO Industries, Inc. All rights reserved.

